



Inductive sensors

replaced by: IG6073

IG5287

IGB3008-ANKG
Inductive sensor
Metal thread M18 x 1
Cable

Sensing range 8mm [nf]
non-flush mountable

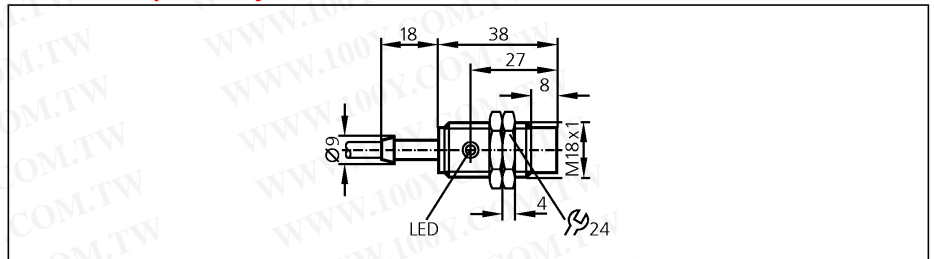

Electrical design	
Output	
Operating voltage	[V]
Current rating	[mA]
Short-circuit protection	
Reverse polarity protection	
Overload protection	
Voltage drop	[V]
Current consumption	[mA]
Real sensing range	[mm]
Operating distance	[mm]
Switch-point drift	[% of Sr]
Hysteresis	[% of Sr]
Switching frequency	[Hz]
Correction factors	
Operating temperature	[°C]
Protection	
EMC	
Housing material	
Function display	
Switching status	LED
Connection	
Accessories (included)	

DC NPN	
normally open	
Operating voltage	18...36 DC
Current rating	150 (...50 °C) / 125 (...80 °C)
Short-circuit protection	Yes (non-latching)
Reverse polarity protection	yes
Overload protection	yes
Voltage drop	< 2.5
Current consumption	< 15 (24 V)
Real sensing range	8 ± 10 %
Operating distance	0...6.5
Switch-point drift	-10...10
Hysteresis	1...15
Switching frequency	200
Correction factors	mild steel = 1 / stainless steel approx. 0.7 / brass approx. 0.4 / Al approx. 0.3 / Cu approx. 0.2
Operating temperature	-25...80
Protection	IP 67, II
EMC	EN 60947-5-2 EN 55011: class B
Housing material	brass nickel-plated; PC (polycarbonate)
Function display	
Switching status	yellow
Connection	PVC cable / 2 m; 3 x 0.5 mm ²
Accessories (included)	2 lock nuts

Wiring

Core colors
BK black
BN brown
BU blue

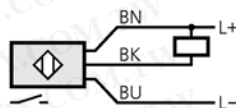

replaced by: IG6073

勝特力材料 886-3-5753170
 勝特力电子(上海) 86-21-54151736
 勝特力电子(深圳) 86-755-83298787
 Http://www.100y.com.tw