

IEEE 1394/6 PIN/RECEPTACLE/DIP 90° TYPE

MATERIAL SPECIFICATION

SHELL	COPPER ALLOY
HOUSING	THERMOPLASTIC, UL94V-0
COLOR	BLACK
CONTACT	COPPER ALLOY

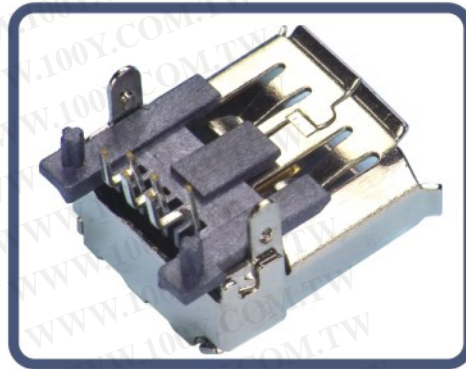

ELECTRICAL CHARACTERISTIC

VOLTAGE CURRENT RATING	1.5AMP, 40V AC
INSULATION RESISTANCE	500 mΩ Min.
CONTACT RESISTANCE	50mΩ Max.
DIELECTRIC WITHSTANDING VOLTAGE	AC 500V R.M.S.
TEMPERATURE RANGE	-20°C TO +85°C

PART NO. SPECIFICATION

I E N F - 06 * N - B R 0 0

勝特力材料 886-3-5753170
 勝特力电子(上海) 86-21-54151736
 勝特力电子(深圳) 86-755-83298787
[Http://www.100y.com.tw](http://www.100y.com.tw)

1 : Au 1U"
 6 : Au 30U"

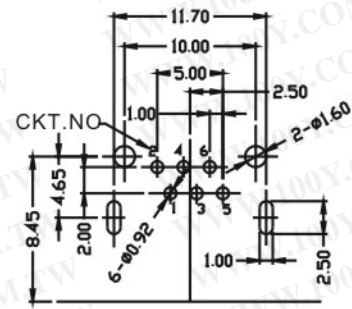

P.C.B LAYOUT

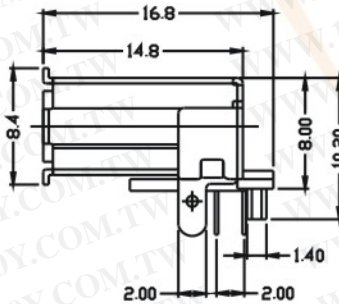
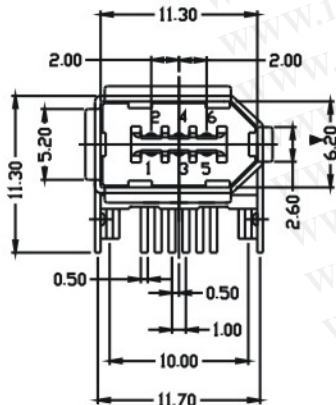
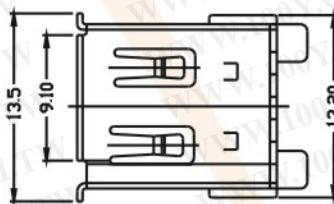

IEEE 1394 CONNECTOR

IEEE 1394/6 PIN/RECEPTACLE/SMT 90° TYPE

MATERIAL SPECIFICATION

SHELL	COPPER ALLOY
HOUSING	THERMOPLASTIC, UL94V-0
COLOR	BLACK
CONTACT	COPPER ALLOY

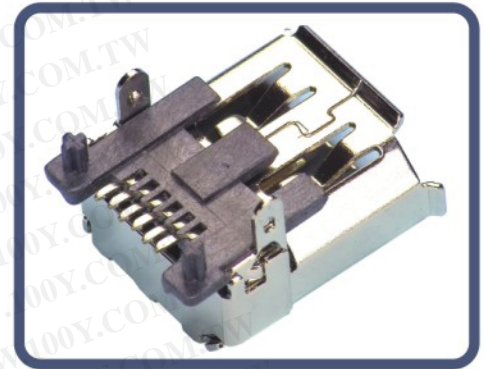

ELECTRICAL CHARACTERISTIC

VOLTAGE CURRENT RATING	1.5AMP, 40V AC
INSULATION RESISTANCE	500 mΩ Min.
CONTACT RESISTANCE	50mΩ Max.
DIELECTRIC WITHSTANDING VOLTAGE	AC 500V R.M.S.
TEMPERATURE RANGE	-20°C TO +85°C

PART NO. SPECIFICATION

I E N F - 06 * N - B V 0 0

1 : Au 1U"
6 : Au 30U"

勝特力材料 886-3-5753170
勝特力电子(上海) 86-21-54151736
勝特力电子(深圳) 86-755-83298787
[Http://www.100y.com.tw](http://www.100y.com.tw)

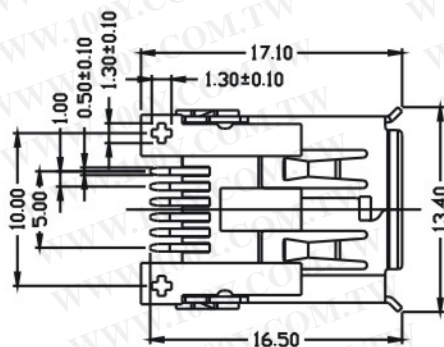
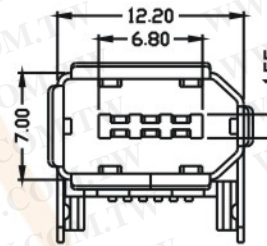
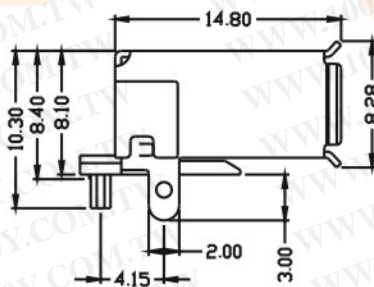
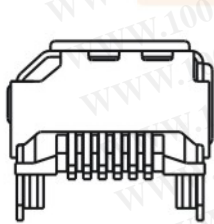
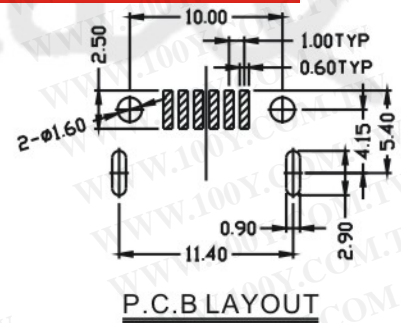

IEEE 1394 CONNECTOR

IEEE 1394/6 PIN/RECEPTACLE/SHORT FLANK DIP 90° TYPE

MATERIAL SPECIFICATION

SHELL	COPPER ALLOY
HOUSING	THERMOPLASTIC, UL94V-0
COLOR	BLACK
CONTACT	COPPER ALLOY



ELECTRICAL CHARACTERISTIC

VOLTAGE CURRENT RATING	1.5AMP, 40V AC
INSULATION RESISTANCE	500 mΩ Min.
CONTACT RESISTANCE	50mΩ Max.
DIELECTRIC WITHSTANDING VOLTAGE	AC 500V R.M.S.
TEMPERATURE RANGE	-20°C TO +85°C

PART NO. SPECIFICATION

IENF-06*N-BC00

勝特力材料 886-3-5753170
 勝特力电子(上海) 86-21-54151736
 勝特力电子(深圳) 86-755-83298787
[Http://www.100y.com.tw](http://www.100y.com.tw)

1 : Au 1U"
 6 : Au 30U"

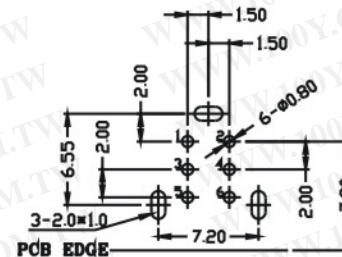

P.C.B LAYOUT

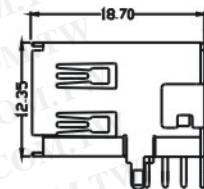
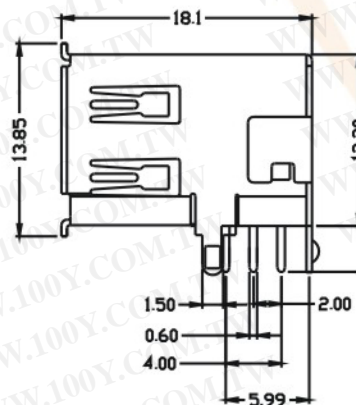
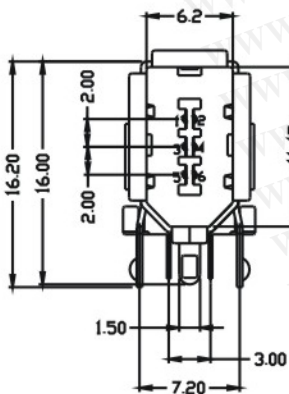

IENF-06*N-BC01

IEEE 1394 CONNECTOR



IEEE 1394/6 PIN/RECEPTACLE/FLANK DIP 90° TYPE

MATERIAL SPECIFICATION

SHELL	COPPER ALLOY
HOUSING	THERMOPLASTIC, UL94V-0
COLOR	BLACK
CONTACT	COPPER ALLOY



ELECTRICAL CHARACTERISTIC

VOLTAGE CURRENT RATING	1.5AMP, 40V AC
INSULATION RESISTANCE	500 mΩ Min.
CONTACT RESISTANCE	50mΩ Max.
DIELECTRIC WITHSTANDING VOLTAGE	AC 500V R.M.S.
TEMPERATURE RANGE	-20°C TO +85°C

PART NO. SPECIFICATION

IENF-06*N-BC30

勝特力材料 886-3-5753170
 勝特力电子(上海) 86-21-54151736
 勝特力电子(深圳) 86-755-83298787
[Http://www.100y.com.tw](http://www.100y.com.tw)

1 : Au 1U"
 6 : Au 30U"

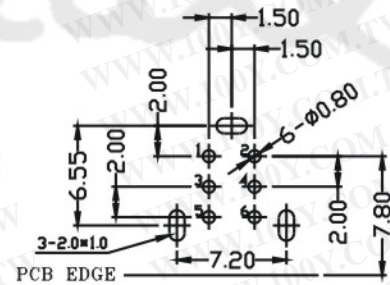

P.C.B LAYOUT

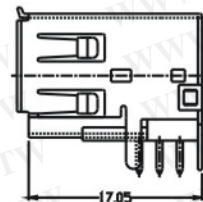
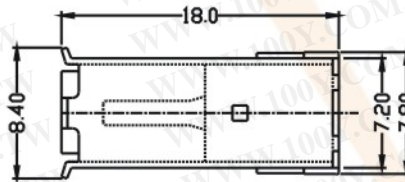

IENF-06*N-BC31

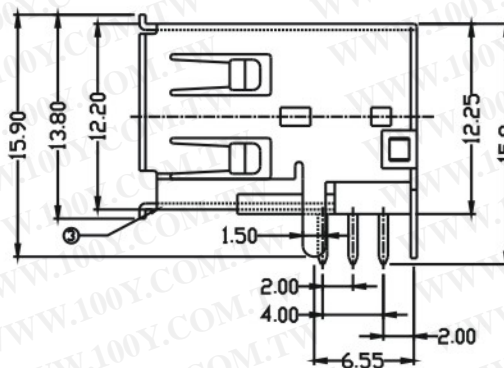
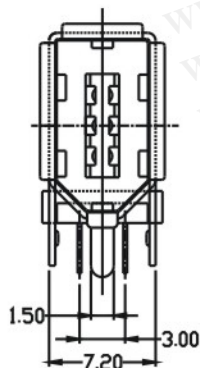

IEEE 1394/6 PIN/RECEPTACLE/DIP 180° TYPE

MATERIAL SPECIFICATION

SHELL	COPPER ALLOY
HOUSING	THERMOPLASTIC, UL94V-0
COLOR	BLACK
CONTACT	COPPER ALLOY

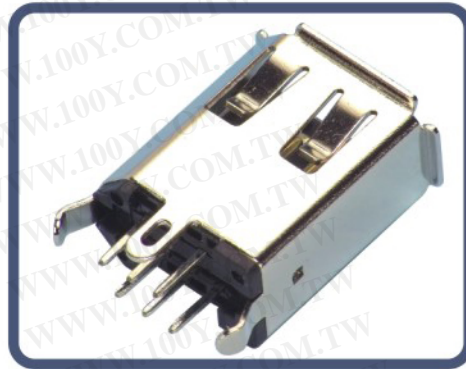

ELECTRICAL CHARACTERISTIC

VOLTAGE CURRENT RATING	1.5AMP, 40V AC
INSULATION RESISTANCE	500 mΩ Min.
CONTACT RESISTANCE	50mΩ Max.
DIELECTRIC WITHSTANDING VOLTAGE	AC 500V R.M.S.
TEMPERATURE RANGE	-20°C TO +85°C

PART NO. SPECIFICATION

I E N F - 06 * N - B P 0 0

勝特力材料 886-3-5753170
 勝特力电子(上海) 86-21-54151736
 勝特力电子(深圳) 86-755-83298787
[Http://www.100y.com.tw](http://www.100y.com.tw)

1 : Au 1U"
 6 : Au 30U"

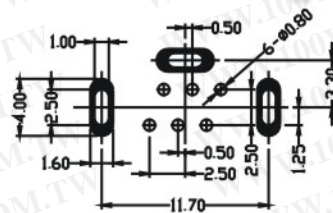
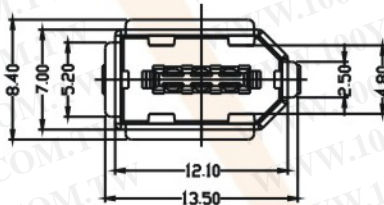

P.C.B LAYOUT

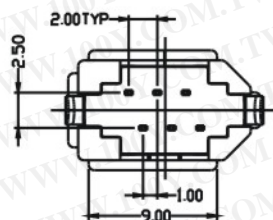
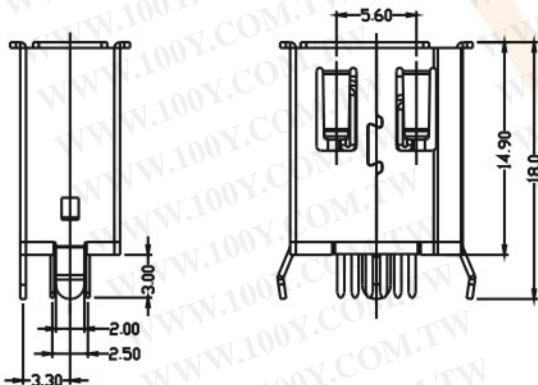

IEEE 1394 CONNECTOR