

STNC 氣動接頭

G 螺紋快速插卸接頭

螺紋直通



型號

PC 04-G01	PC 04-G02	PC 06-G01
PC 06-G02	PC 06-G03	PC 06-G04
PC 08-G01	PC 08-G02	PC 08-G03
PC 08-G04	PC 10-G01	PC 10-G02
PC 10-G03	PC 10-G04	PC 12-G01
PC 12-G02	PC 12-G03	PC 12-G04
PC 16-G03	PC 16-G04	

L 型螺紋二通



型號

PL 04-G01	PL 04-G02	PL 06-G01
PL 06-G02	PL 06-G03	PL 06-G04
PL 08-G01	PL 08-G02	PL 08-G03
PL 08-G04	PL 10-G01	PL 10-G02
PL 10-G03	PL 10-G04	PL 12-G01
PL 12-G02	PL 12-G03	PL 12-G04
PL 16-G03	PL 16-G04	

T 型螺紋三通



型號

PT 04-G01	PT 04-G02	PT 06-G01
PT 06-G02	PT 06-G03	PT 08-G01
PT 08-G02	PT 08-G03	PT 08-G04
PT 10-G01	PT 10-G02	PT 10-G03
PT 10-G04	PT 12-G02	PT 12-G03
PT 12-G04	PT 16-G03	PT 16-G04

外六角接頭



型號

PH 04-G01	PH 04-G02	PH 06-G01
PH 06-G02	PH 06-G03	PH 08-G01
PH 08-G02	PH 08-G03	PH 08-G04
PH 10-G01	PH 10-G02	PH 10-G03
PH 10-G04	PH 12-G02	PH 12-G03
PH 12-G04		

T 型分支螺紋三通



型號

PST 04-G01	PST 04-G02	PST 06-G01
PST 06-G02	PST 06-G03	PST 08-G01
PST 08-G02	PST 08-G03	PST 08-G04
PST 10-G01	PST 10-G02	PST 10-G03
PST 10-G04	PST 12-G02	PST 12-G03
PST 12-G04	PST 16-G03	PST 16-G04

Y 型螺紋三通



型號

PWT 04-G01	PWT 04-G02	PWT 06-G01
PWT 06-G02	PWT 06-G03	PWT 08-G01
PWT 08-G02	PWT 08-G03	PWT 08-G04
PWT 10-G01	PWT 10-G02	PWT 10-G03
PWT 10-G04	PWT 12-G02	PWT 12-G03
PWT 12-G04	PWT 16-G03	PWT 16-G04

L 型內螺紋二通



型號

PLF 04-G01	PLF 04-G02	PLF 06-G01
PLF 06-G02	PLF 06-G03	PLF 08-G01
PLF 08-G02	PLF 08-G03	PLF 08-G04
PLF 10-G01	PLF 10-G02	PLF 10-G03
PLF 10-G04	PLF 12-G02	PLF 12-G03
PLF 12-G04		

內螺紋直通



型號

PCF 04-G01	PCF 04-G02	PCF 06-G01
PCF 06-G02	PCF 06-G03	PCF 08-G01
PCF 08-G02	PCF 08-G03	PCF 08-G04
PCF 10-G01	PCF 10-G02	PCF 10-G03
PCF 10-G04	PCF 12-G02	PCF 12-G03
PCF 12-G04		

L 型加長螺紋二通



型號

PLL 04-G01	PLL 04-G02	PLL 06-G01
PLL 06-G02	PLL 06-G03	PLL 08-G01
PLL 08-G02	PLL 08-G03	PLL 08-G04
PLL 10-G01	PLL 10-G02	PLL 10-G03
PLL 10-G04	PLL 12-G02	PLL 12-G03
PLL 12-G04	PLL 16-G03	PLL 16-G04

■ 特性

1. 快速安装，简单灵巧，节省空间。
2. 型式多样，满足不同的气动布管需要。
3. 安装后塑料管体可任意转向。
4. 所有锥管螺纹涂聚四氟乙烯防漏胶，密封性好。
5. 所有的 YPC 型直通接头均带内六角孔便于狭窄环境安装。

● 使用须知

1. 请勿给管接头外加拉力，卷绕、弯曲等负荷否则有导致接头损坏的危险。
2. 不要使用温度 60℃ 以上的热水或热介质油，因热及加水分解会导致接头破损。
3. 请勿使用空气、水（有条件）以外的其他流体介质。

● 订购代码

Y - PC 8 - 01
 Y: 白色 型号 管子外径 螺纹
 T: 黑色

■ 螺纹型式及尺寸

公制螺纹

编号	M5	M6	M8	M10	M12	M12A	M16
尺寸	M5x0.8	M6x1	M8x1	M10x1	M12x1.25	M12x1.5	M16x1.5

锥管螺纹

编号	O1	O2	O3	O4		
尺寸	R1/8	R1/4	R3/8	R1/2		

直管螺纹

编号	G01	G02	G03	G04		
尺寸	G1/8	G1/4	G3/8	G1/2		

■ 技术参数

流体	空气
使用压力范围	0 - 0.8 MPa
耐压	1.5 Mpa
使用温度范围	-10 ~ 60℃ (但不冻结)
使用气管种类	PU 或 PA



● YPC/TPC 螺纹直通



型号	∅D	R	A	B	H
YPC4-M5	4	M5	4	19	10
YPC4-M6	4	M6	4.2	19	10
YPC4-O1	4	R1/8	7	20	10
YPC4-O2	4	R1/4	9.5	20	14
YPC6-M5	6	M5	4	20.5	12
YPC6-M6	6	M6	4.2	19	12
YPC6-O1	6	R1/8	7	20.5	12
YPC6-O2	6	R1/4	9.5	21	14
YPC6-O3	6	R3/8	10.5	21.5	17
YPC6-O4	6	R1/2	13	24.5	21
YPC8-O1	8	R1/8	7	25.5	14
YPC8-O2	8	R1/4	9.5	25	14
YPC8-O3	8	R3/8	10.5	23	17
YPC8-O4	8	R1/2	13	24.5	21
YPC10-O1	10	R1/8	7	27	17
YPC10-O2	10	R1/4	9.5	29.5	17
YPC10-O3	10	R3/8	10.5	28	17
YPC10-O4	10	R1/2	13	26	21
YPC12-O2	12	R1/4	9.5	31	19
YPC12-O3	12	R3/8	10.5	28.5	19
YPC12-O4	12	R1/2	13	28.5	21
YPC14-O3	14	R3/8	10.5	38.5	21
YPC14-O4	14	R1/2	13	39	21
YPC16-O3	16	R3/8	10.5	39.5	24
YPC16-O4	16	R1/2	15	40	24



● YPL/TPL L型螺纹二通

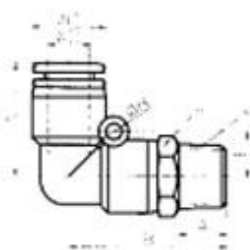

型号	ϕD	E	B	ϕP	A	R	H	F	ϕd
YPL4-M5	4	16.8	21.3	10.5	4	M5	10	-	-
YPL4-01	4	16.8	24.3	10.5	7	R1/8	10	-	-
YPL4-02	4	16.8	26.8	10.5	9.5	R1/4	14	-	-
YPL6-M5	6	19	23	13	4	M5	12	8	3.2
YPL6-01	6	19	26	13	7	R1/8	12	8	3.2
YPL6-02	6	19	28.5	13	9.5	R1/4	14	8	3.2
YPL6-03	6	19	30	13	10.5	R3/8	17	8	3.2
YPL6-04	6	19	34	13	13	R1/2	21	8	3.2
YPL8-01	8	23	29.5	14.4	7	R1/8	14	9	3.2
YPL8-02	8	23	32	14.4	9.5	R1/4	14	9	3.2
YPL8-03	8	23	33	14.4	10.5	R3/8	17	9	3.2
YPL8-04	8	23	37	14.4	13	R1/2	21	9	3.2
YPL10-01	10	27.5	33.5	18.4	7	R1/8	17	12	4.2
YPL10-02	10	27.5	36	18.4	9.5	R1/4	17	12	4.2
YPL10-03	10	27.5	37	18.4	10.5	R3/8	17	12	4.2
YPL10-04	10	27.5	41	18.4	13	R1/2	21	12	4.2
YPL12-02	12	30	38	20	9.5	R1/4	19	13.2	4.2
YPL12-03	12	30	39	20	10.5	R3/8	19	13.2	4.2
YPL12-04	12	30	43	20	13	R1/2	21	13.2	4.2
YPL16-03	16	33.3	44.3	25.6	12	R3/8	24	-	-
YPL16-04	16	33.3	47.3	25.6	15	R1/2	24	-	-



● YPLL/TPLL L型加长螺纹

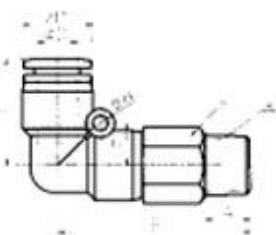

型号	ϕD	E	B	ϕP	A	R	H	F	ϕd
YPLL4-M5	4	16.8	32.3	10.5	4	M5	10	-	-
YPLL4-01	4	16.8	35.3	10.5	7	R1/8	10	-	-
YPLL4-02	4	16.8	37.8	10.5	9.5	R1/4	14	-	-
YPLL6-M5	6	19	35	13	4	M5	12	8	3.2
YPLL6-01	6	19	38	13	7	R1/8	12	8	3.2
YPLL6-02	6	19	41	13	9.5	R1/4	14	8	3.2
YPLL6-03	6	19	43	13	10.5	R3/8	17	8	3.2
YPLL6-04	6	19	47	13	13	R1/2	21	8	3.2
YPLL8-01	8	23	43	14.4	7	R1/8	14	9	3.2
YPLL8-02	8	23	46	14.4	9.5	R1/4	14	9	3.2
YPLL8-03	8	23	47	14.4	10.5	R3/8	17	9	3.2
YPLL8-04	8	23	52	14.4	13	R1/2	21	9	3.2
YPLL10-01	10	27.5	49.5	18.4	7	R1/8	17	12	4.2
YPLL10-02	10	27.5	52	18.4	9.5	R1/4	17	12	4.2
YPLL10-03	10	27.5	54	18.4	10.5	R3/8	17	12	4.2
YPLL10-04	10	27.5	58	18.4	13	R1/2	21	12	4.2
YPLL12-02	12	30	58	20	9.5	R1/4	19	13.2	4.2
YPLL12-03	12	30	59	20	10.5	R3/8	19	13.2	4.2
YPLL12-04	12	30	63	20	13	R1/2	21	13.2	4.2



● YPD/TPD T型分支螺纹三通

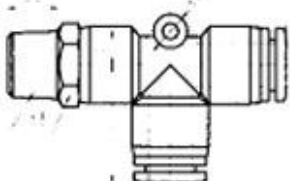

型号	ϕD	E	B	ϕP	A	R	H	F	ϕd
YPD4-M5	4	17	40	10.5	4	M5	10	5	3.2
YPD4-01	4	17	43	10.5	7	R1/8	10	5	3.2
YPD4-02	4	17	45.5	10.5	9.5	R1/4	14	5	3.2
YPD6-M5	6	19	41.5	13	4	M5	12	5.5	3.2
YPD6-01	6	19	44.5	13	7	R1/8	12	5.5	3.2
YPD6-02	6	19	47	13	9.5	R1/4	14	5.5	3.2
YPD6-03	6	19	48.5	13	10.5	R3/8	17	5.5	3.2
YPD6-04	6	19	52.5	13	13	R1/2	21	5.5	3.2
YPD8-01	8	22.5	51.5	14.4	7	R1/8	14	6.5	3.2
YPD8-02	8	22.5	54	14.4	9.5	R1/4	14	6.5	3.2
YPD8-03	8	22.5	55	14.4	10.5	R3/8	17	6.5	3.2
YPD8-04	8	22.5	59	14.4	13	R1/2	21	6.5	3.2
YPD10-01	10	28	62	18.4	7	R1/8	17	8	4.2
YPD10-02	10	28	64.5	18.4	9.5	R1/4	17	8	4.2
YPD10-03	10	28	65.5	18.4	10.5	R3/8	17	8	4.2
YPD10-04	10	28	69.5	18.4	13	R1/2	21	8	4.2
YPD12-02	12	31	68	20	9.5	R1/4	19	8.5	4.2
YPD12-03	12	31	69	20	10.5	R3/8	19	8.5	4.2
YPD12-04	12	31	72.5	20	13	R1/2	21	8.5	4.2



● YPB/TPB T型螺纹三通

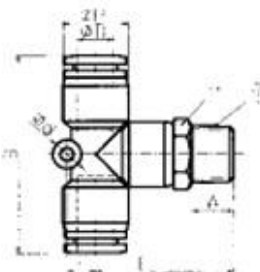

型号	ϕD	E	B	ϕP	A	R	H	F	ϕd
YPB4-M5	4	21.5	35.5	10.5	4	M5	10	5	3.2
YPB4-01	4	24.5	35.5	10.5	7	R1/8	10	5	3.2
YPB4-02	4	27	35.5	10.5	9.5	R1/4	14	5	3.2
YPB6-M5	6	23	37.5	13	4	M5	12	5.5	3.2
YPB6-01	6	26	37.5	13	7	R1/8	12	5.5	3.2
YPB6-02	6	28.5	37.5	13	9.5	R1/4	14	5.5	3.2
YPB6-03	6	30	37.5	13	10.5	R3/8	17	5.5	3.2
YPB6-04	6	34	37.5	13	13	R1/2	21	5.5	3.2
YPB8-01	8	29	45	14.4	7	R1/8	14	6.5	3.2
YPB8-02	8	31.5	45	14.4	9.5	R1/4	14	6.5	3.2
YPB8-03	8	32.5	45	14.4	10.5	R3/8	17	6.5	3.2
YPB8-04	8	36.5	45	14.4	13	R1/2	21	6.5	3.2
YPB10-01	10	34	56	18.4	7	R1/8	17	8	4.2
YPB10-02	10	35	56	18.4	9.5	R1/4	17	8	4.2
YPB10-03	10	37.5	56	18.4	10.5	R3/8	17	8	4.2
YPB10-04	10	41.5	56	18.4	13	R1/2	21	8	4.2
YPB12-02	12	39	60	20	9.5	R1/4	19	8.5	4.2
YPB12-03	12	40	60	20	10.5	R3/8	19	8.5	4.2
YPB12-04	12	43.5	60	20	13	R1/2	21	8.5	4.2
YPB16-03	16	44.3	63	25.6	12	R3/8	24	-	-
YPB16-04	16	47.3	63	25.6	15	R1/2	24	-	-



● YPX/TPX Y型螺纹三通

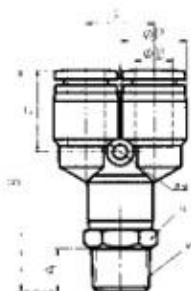

型号	ϕD	E	B	ϕP	A	R	H	F	ϕd
YPX4-M5	4	10.5	39	10.5	4	M5	10	13.5	-
YPX4-01	4	10.5	42	10.5	7	R1/8	10	13.5	-
YPX4-02	4	10.5	44.5	10.5	9.5	R1/4	14	13.5	-
YPX6-M5	6	13	40.5	13	4	M5	12	14.5	3.2
YPX6-01	6	13	43.5	13	7	R1/8	12	14.5	3.2
YPX6-02	6	13	46	13	9.5	R1/4	14	14.5	3.2
YPX6-03	6	13	47.5	13	10.5	R3/8	17	14.5	3.2
YPX6-04	6	13	51.5	13	13	R1/2	21	14.5	3.2
YPX8-01	8	14.5	47.5	14.4	7	R1/8	14	18.5	3.2
YPX8-02	8	14.5	50	14.4	9.5	R1/4	14	18.5	3.2
YPX8-03	8	14.5	51	14.4	10.5	R3/8	17	18.5	3.2
YPX8-04	8	14.5	55	14.4	13	R1/2	21	18.5	3.2
YPX10-01	10	18.5	56	18.4	7	R1/8	17	21	4.2
YPX10-02	10	18.5	58.5	18.4	9.5	R1/4	17	21	4.2
YPX10-03	10	18.5	59.5	18.4	10.5	R3/8	17	21	4.2
YPX10-04	10	18.5	63.5	18.4	13	R1/2	21	21	4.2
YPX12-02	12	20	63	20	9.5	R1/4	19	22.5	4.2
YPX12-03	12	20	64	20	10.5	R3/8	19	22.5	4.2
YPX12-04	12	20	67.5	20	13	R1/2	21	22.5	4.2



● YPH/TPH 外六角接头

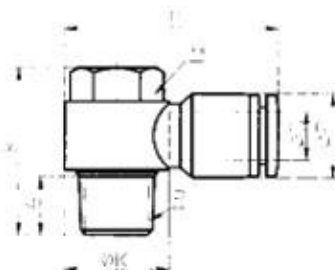

型号	ϕD	E	B	ϕP	A	R	H	ϕK
YPH4-M5	4	24	18	10.5	3.5	M5	10	10
YPH4-01	4	28	25	10.5	7	R1/8	10	14
YPH4-02	4	32	29	10.5	10	R1/4	14	15
YPH6-M5	6	28	18	13	3.5	M5	12	10
YPH6-01	6	32	25	13	7	R1/8	12	14
YPH6-02	6	36	29	13	10	R1/4	14	18
YPH6-03	6	40	34.5	13	11	R3/8	17	22
YPH6-04	6	45.5	39	13	13	R1/2	21	27.5
YPH8-01	8	32.5	25	14.4	7	R1/8	14	14
YPH8-02	8	36.5	29	14.4	10	R1/4	14	18
YPH8-03	8	40.5	34.5	14.4	11	R3/8	17	22
YPH8-04	8	46	39	14.4	13	R1/2	21	27.5
YPH10-01	10	34.5	25	18.4	7	R1/8	17	14
YPH10-02	10	38.5	29	18.4	10	R1/4	17	18
YPH10-03	10	42.5	34.5	18.4	11	R3/8	17	22
YPH10-04	10	48	39	18.4	13	R1/2	21	27.5
YPH12-02	12	41.5	29	20	10	R1/4	19	18
YPH12-03	12	45.5	34.5	20	11	R3/8	19	22
YPH12-04	12	51	39	20	13	R1/2	21	27.5



● YPLF/TPLF L型内螺纹二通

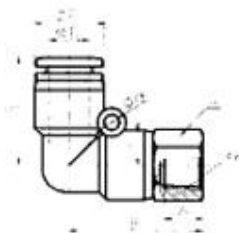

型号	ϕD	E	B	ϕP	A	Rc	H	F	ϕd
YPLF4-M5	4	16.8	18.3	10.5	4	M5	10	-	-
YPLF4-01	4	16.8	22.8	10.5	7	Rc1/8	14	-	-
YPLF4-02	4	16.8	25.8	10.5	10	Rc1/4	17	-	-
YPLF6-M5	6	19	21.8	13	4	M5	12	8	3.2
YPLF6-01	6	19	24.8	13	7	Rc1/8	12	8	3.2
YPLF6-02	6	19	27.8	13	10	Rc1/4	17	8	3.2
YPLF6-03	6	19	28.8	13	11	Rc3/8	21	8	3.2
YPLF6-04	6	19	30.8	13	13	Rc1/2	24	8	3.2
YPLF8-01	8	23	27	14.4	7	Rc1/8	14	9	3.2
YPLF8-02	8	23	31	14.4	10	Rc1/4	17	9	3.2
YPLF8-03	8	23	32	14.4	11	Rc3/8	21	9	3.2
YPLF8-04	8	23	34	14.4	13	Rc1/2	24	9	3.2
YPLF10-01	10	27.5	31	18.4	7	Rc1/8	17	12	4.2
YPLF10-02	10	27.5	35	18.4	10	Rc1/4	17	12	4.2
YPLF10-03	10	27.5	36	18.4	11	Rc3/8	21	12	4.2
YPLF10-04	10	27.5	38	18.4	13	Rc1/2	24	12	4.2
YPLF12-02	12	30	36.5	20	10	Rc1/4	21	13.2	4.2
YPLF12-03	12	30	37.5	20	11	Rc3/8	21	13.2	4.2
YPLF12-04	12	30	39.5	20	13	Rc1/2	24	13.2	4.2



● YPCF/TPCF 内螺纹直通

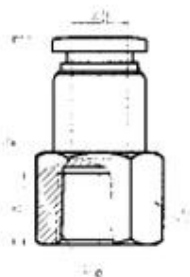

型号	ϕD	Rc	A	B	H
YPCF4-M5	4	M5	4	21	10
YPCF4-01	4	Rc1/8	7	23.5	14
YPCF4-02	4	Rc1/4	9.5	26.5	17
YPCF6-M5	6	M5	4	21	12
YPCF6-01	6	Rc1/8	7	24	12
YPCF6-02	6	Rc1/4	9.5	27	17
YPCF6-03	6	Rc3/8	10.5	28	21
YPCF6-04	6	Rc1/2	13	30	24
YPCF8-01	8	Rc1/8	7	27	14
YPCF8-02	8	Rc1/4	9.5	30	17
YPCF8-03	8	Rc3/8	10.5	31	21
YPCF8-04	8	Rc1/2	13	33	24
YPCF10-01	10	Rc1/8	7	28.5	17
YPCF10-02	10	Rc1/4	9.5	31.5	17
YPCF10-03	10	Rc3/8	10.5	32.5	21
YPCF10-04	10	Rc1/2	13	34.5	24
YPCF12-02	12	Rc1/4	9.5	32.5	21
YPCF12-03	12	Rc3/8	10.5	33.5	21
YPCF12-04	12	Rc1/2	13	35.5	24



● YPHF/TPHF 串联接头

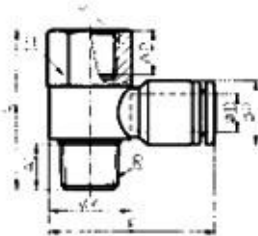

型号	ϕD	E	B	ϕP	A1	A2	Rc	R	H	ϕK
YPHF4-M5	4	24	19	10.5	3.5	4	M5	M5	8	10
YPHF4-01	4	28	29.5	10.5	7	7	Rc1/8	R1/8	12	14
YPHF4-02	4	32	35.5	10.5	10	10	Rc1/4	R1/4	17	15
YPHF6-M5	6	28	19	13	3.5	4	M5	M5	8	10
YPHF6-01	6	32	29.5	13	7	7	Rc1/8	R1/8	12	14
YPHF6-02	6	36	35.5	13	10	10	Rc1/4	R1/4	17	18
YPHF6-03	6	44.0	41.5	13	11	11	Rc3/8	R3/8	21	22
YPHF6-04	6	45.5	48.5	13	13	13	Rc1/2	R1/2	24	27.5
YPHF8-01	8	32.5	29.5	14.4	7	7	Rc1/8	R1/8	12	14
YPHF8-02	8	36.5	35.5	14.4	10	10	Rc1/4	R1/4	17	18
YPHF8-03	8	40.5	41.5	14.4	11	11	Rc3/8	R3/8	21	22
YPHF8-04	8	46	48.5	14.4	13	13	Rc1/2	R1/2	24	27.5
YPHF10-01	10	34.5	29.5	18.4	7	7	Rc1/8	R1/8	12	14
YPHF10-02	10	38.5	35.5	18.4	10	10	Rc1/4	R1/4	17	18
YPHF10-03	10	42.5	41.5	18.4	11	11	Rc3/8	R3/8	21	22
YPHF10-04	10	48	48.5	18.4	13	13	Rc1/2	R1/2	24	27.5
YPHF12-02	12	41.5	35.5	20	10	10	Rc1/4	R1/4	17	18
YPHF12-03	12	45.5	41.5	20	11	11	Rc3/8	R3/8	21	22
YPHF12-04	12	51	48.5	20	13	13	Rc1/2	R1/2	24	27.5



● YSC/TSC 直接安装 L 型

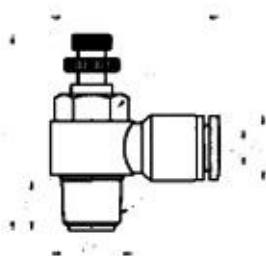

型号	ϕD	E	B	ϕP	A	R	H	ϕK
YSC4-M5	4	24	28	10.5	3.5	M5	8	10
YSC4-01	4	28	37	10.5	7.5	R1/8	12	14
YSC4-02	4	32	44.5	10.5	11	R1/4	14	15
YSC6-M5	6	28	28	13	3.5	M5	8	10
YSC6-01	6	32	37	13	7.5	R1/8	12	14
YSC6-02	6	36	44.5	13	11	R1/4	14	18
YSC6-03	6	40	48	13	12	R3/8	19	22
YSC6-04	6	45.5	52.5	13	12.5	R1/2	24	27.5
YSC8-01	8	32.5	37	14.4	7.5	R1/8	12	14
YSC8-02	8	36.5	44.5	14.4	11	R1/4	14	18
YSC8-03	8	40.5	48	14.4	12	R3/8	19	22
YSC8-04	8	46	52.5	14.4	12.5	R1/2	24	27.5
YSC10-01	10	34.5	37	18.4	7.5	R1/8	12	14
YSC10-02	10	38.5	44.5	18.4	11	R1/4	14	18
YSC10-03	10	42.5	48	18.4	12	R3/8	19	22
YSC10-04	10	48	52.5	18.4	12.5	R1/2	24	27.5
YSC12-02	12	41.5	44.5	20	11	R1/4	14	18
YSC12-03	12	45.5	48	20	12	R3/8	19	22
YSC12-04	12	51	52.5	20	12.5	R1/2	24	27.5



● YPY/TPY Y型三通

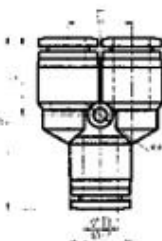

型号	ϕD	B	ϕP	E	F	ϕd
YPY4	4	34.5	10.5	10.5	13.5	3.2
YPY6	6	36.5	13	13	14.5	3.2
YPY8	8	41	14.4	14.5	18.5	3.2
YPY10	10	50	18.4	18.5	21	4.2
YPY12	12	55	20	20	22.5	4.2
YPY14	14	55	25.6	26	25.5	4.8
YPY16	16	55	25.6	26	25.5	4.8



● YPYW Y型变径三通

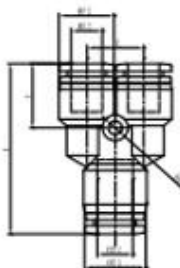

型号	$\phi D1$	2- $\phi D2$	B	$\phi P1$	$\phi P2$	E	F	ϕd
YPYW6-4	6	4	36	13	10.5	10.5	13.5	3.2
YPYW8-6	8	6	38	14.4	13	13	14.5	3.2
YPYW10-8	10	8	43	18.4	14.4	14.5	18.5	3.2
YPYW12-10	12	10	53	20	18.4	18.5	21	4.2



● YPE/TPE T型三通

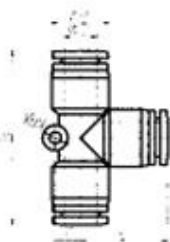

型号	ϕD	B	ϕP	E	F	ϕd
YPE4	4	35.5	10.5	17	5	3.2
YPE6	6	37.5	13	19	5.5	3.2
YPE8	8	45	14.4	22.5	6.5	3.2
YPE10	10	56	18.4	28	8	4.2
YPE12	12	60	20	31	8.5	4.2
YPE14	14	62	25.6	31	—	4.8
YPY16	16	55	25.6	31	—	4.8



● YPEW T型变径三通

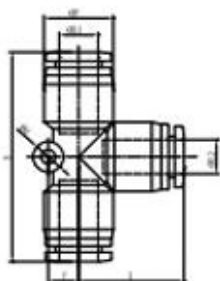

型号	2-φD1	φD2	B	φP	E	F	φd
YPEW6-4	6	4	37.5	13	19	5.5	3.2
YPEW8-6	8	6	45	14.4	22.5	6.5	3.2
YPEW10-8	10	8	56	18.4	28	8	4.2
YPEW12-10	12	10	60	20	31	8.5	4.2



● YPV/TPV L型二通

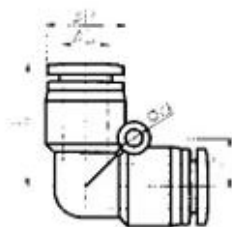

型号	φD	E	φp	F	φd
YPV4	4	16.8	10.5	—	—
YPV6	6	19	13	8	3.2
YPV8	8	23	14.4	9	3.2
YPV10	10	27.5	18.4	12	4.2
YPV12	12	30	20	13.2	4.2
YPV14	14	32	25.6	15.5	4.8
YPV16	16	32	25.6	15.5	4.8



● YPP/TPP 管塞

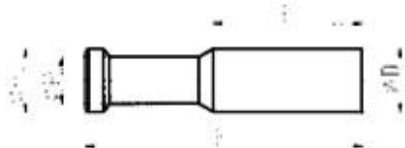

型号	φD	E	φP2	B	φP
YPP4	4	16	4	28	3
YPP6	6	17	6	32	4
YPP8	8	18.5	8	39	5
YPP10	10	21	10	42	8
YPP12	12	22.5	12	44	8



● YPLGJ/TPLGJ L型减径二通

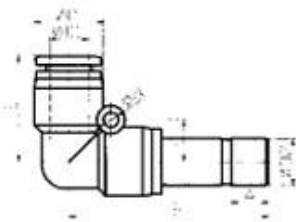

型号	$\phi D1$	E	B	ϕP	A	$\phi D2$	F	ϕd
YPLGJ6-4	4	16,8	32,3	10,5	6	6	—	—
YPLGJ8-4	4	16,8	35,3	10,5	6	8	—	—
YPLGJ8-6	6	19	37	13	6	8	8	3,2
YPLGJ10-6	6	19	40	13	6	10	8	3,2
YPLGJ10-8	8	23	43	14,4	8	10	9	3,2
YPLGJ12-8	8	23	43	14,4	8	12	9	3,2
YPLGJ12-10	10	27,5	47	18,4	8	12	12	4,2



● YPZA/TPZA 十字四通

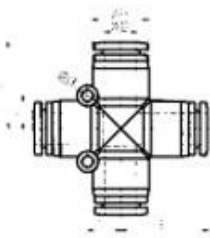

型号	ϕD	E	ϕp	F	ϕd
YPZA4	4	19	10,5	7	3,2
YPZA6	6	19,8	13	7,5	3,2
YPZA8	8	23	14,4	8,8	3,2
YPZA10	10	29	18,4	11,5	4,2
YPZA12	12	30	20	11,5	4,2
YPZA14	14	32	25,6	15,5	4,8
YPZA16	16	32	25,6	15,5	4,8



● YPKD/TPKD 减径螺纹五通

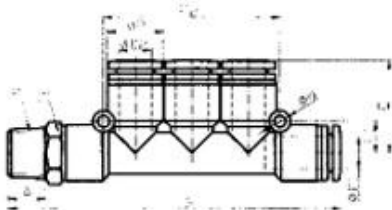

型号	$\phi D1$	$\phi D2$	B	E	A	R	F2	ϕP	H	F1	ϕd
YPKD6-4-01	6	4	74	20	7	R1/8	40	13	12	7	3,2
YPKD6-4-02	6	4	76,5	20	9,5	R1/4	40	13	14	7	3,2
YPKD6-4-03	6	4	78	20	10,5	R3/8	40	13	17	7	3,2
YPKD8-6-01	8	6	81,5	23	7	R1/8	45,5	14,5	14	8,2	3,2
YPKD8-6-02	8	6	84	23	9,5	R1/4	45,5	14,5	14	8,2	3,2
YPKD8-6-03	8	6	85	23	10,5	R3/8	45,5	14,5	17	8,2	3,2
YPKD10-8-02	10	8	101,5	27,5	9,5	R1/8	56,4	18	17	9,8	3,2
YPKD10-8-03	10	8	102,5	27,5	10,5	R3/8	56,4	18	17	9,8	3,2
YPKD10-8-04	10	8	106,5	27,5	13	R1/2	56,4	18	21	9,8	3,2
YPKD12-10-02	12	10	107,5	29	9,5	R1/8	63	20	19	11,5	4,2
YPKD12-10-03	12	10	108,5	29	10,5	R3/8	63	20	19	11,5	4,2
YPKD12-10-04	12	10	112	29	13	R1/2	63	20	21	11,5	4,2



● YPG/TPG 减径直通

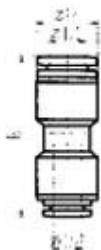

型号	$\phi D1$	$\phi D2$	B	ϕP
YPG6-4	6	4	26	13
YPG8-6	8	6	29	14.5
YPG10-8	10	8	36	18.4
YPG12-10	12	10	37	20
YPG16-12	16	12	40	25.6



● YPU/TPU 直通



型号	ϕD	B	ϕP
YPU4	4	25	10.5
YPU6	6	26	13
YPU8	8	29	14.5
YPU10	10	36	18.4
YPU12	12	37	20
YPU14	14	44	25.6
YPU16	16	44	25.6



● YPKG/TPKG 减径五通

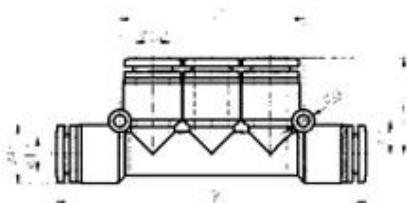

型号	ϕD	B	$\phi D2$	E	F2	ϕP	F1	ϕd
YPKG6-4	6	67	4	20	40	13	7	3.2
YPKG8-6	8	75	6	23	45.5	14.5	8.2	3.2
YPKG10-8	10	93	8	27.5	56.4	18	9.8	4.2
YPKG12-10	12	99.5	10	29	63	20	11.5	4.2



● YPKB/TPKB 螺纹五通

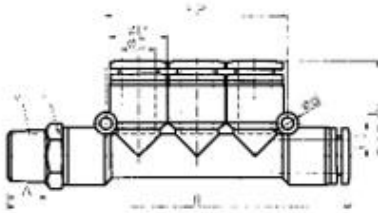

型号	$\phi D1$	B	E	A	R	F2	ϕP	H	F1	ϕd
YPKB4-01	4	70	19	7	R1/8	34.2	10.5	10	6.5	3.2
YPKB6-01	6	74	20.5	7	R1/8	40	13	12	7	3.2
YPKB6-02	6	76.5	20.5	9.5	R1/4	40	13	14	7	3.2
YPKB6-03	6	78	20.5	10.5	R3/8	40	13	17	7	3.2
YPKB8-01	8	81.5	24	7	R1/8	45.5	14.5	14	8.2	3.2
YPKB8-02	8	84	24	9.5	R1/4	45.5	14.5	14	8.2	3.2
YPKB8-03	8	85	24	10.5	R3/8	45.5	14.5	17	8.2	3.2
YPKB10-02	10	101.5	28	9.5	R1/8	56.4	18	17	9.8	3.2
YPKB10-03	10	102.5	28	10.5	R3/8	56.4	18	17	9.8	3.2
YPKB10-04	10	106.5	28	13	R1/2	56.4	18	21	9.8	3.2
YPKB12-02	12	107.5	30	9.5	R1/8	63	20	19	11.5	4.2
YPKB12-03	12	108.5	30	10.5	R3/8	63	20	19	11.5	4.2
YPKB12-04	12	112	30	13	R1/2	63	20	21	11.5	4.2



● YPGJ/TPGJ 减径直通接头

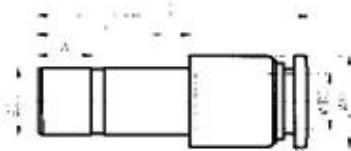

型号	ϕD	E	$\phi D2$	B	A	ϕP
YPGJ6-4	4	17	6	32.5	6	10
YPGJ8-4	4	20	8	35.5	6	10
YPGJ8-6	6	20	8	36.5	6	12
YPGJ10-6	6	23	10	39.5	8	12
YPGJ10-8	8	23	10	39.5	8	14
YPGJ12-8	8	23	12	42	8	14
YPGJ12-10	12	23	12	44	8	17



● YPM/TPM 隔板直通

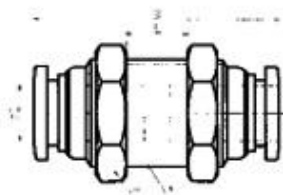

型号	ϕD	B	E	R	H
YPM4	4	31	8	M12x1	17
YPM6	6	34	10	M14x1	19
YPM8	8	38	12	M16x1	22
YPM10	10	42	15	M20x1	27
YPM12	12	45	16	M22x1	30



● YPK/TPK 五通

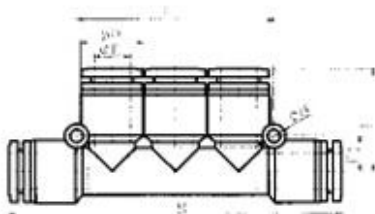

型号	ϕD	B	E	F2	ϕP	F1	ϕd
YPK4	4	60	19	34.2	10.5	6.5	3.2
YPK6	6	67	20.5	40	13	7	3.2
YPK8	8	75	24	45.5	14.5	8.2	3.2
YPK10	10	93	28	56.4	18	9.8	4.2
YPK12	12	99.5	30	63	20	11.5	4.2



● YPEGJ/TPEGJ T型减径三通

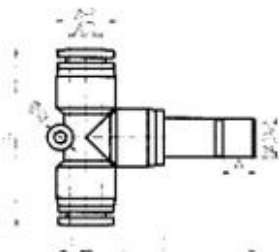

型号	$\phi D1$	E	B	ϕP	A	$\phi D2$	F	ϕd
YPEGJ6-4	4	32.5	35.5	10.5	6	6	5	3.2
YPEGJ8-4	4	35.5	35.5	10.5	6	8	5	3.2
YPEGJ8-6	6	37	37.5	13	6	8	5.5	3.2
YPEGJ10-6	6	40	37.5	13	6	10	5.5	3.2
YPEGJ10-8	8	42.5	45	14.4	8	10	6.5	3.2
YPEGJ12-8	8	42.5	45	14.4	8	12	6.5	3.2
YPEGJ12-10	10	48	56	18.4	8	12	8	4.2



● YPWJ/TPWJ Y型减径三通

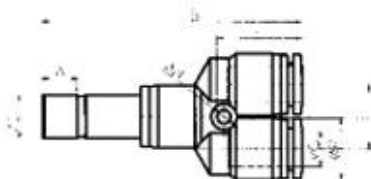

型号	$\phi D1$	E	B	ϕP	A	$\phi D2$	F	ϕd
YPWJ6-4	4	10.5	50	10.5	6	6	13.5	3.2
YPWJ6-4	4	10.5	53	10.5	6	8	13.5	3.2
YPWJ8-6	6	13	54.5	13	6	8	14.5	3.2
YPWJ10-6	6	13	57.5	13	6	10	14.5	3.2
YPWJ10-8	8	14.5	61	14.4	8	10	18.5	3.2
YPWJ12-8	8	14.5	61	14.4	8	12	18.5	3.2
YPWJ12-10	10	18.5	69.5	18.4	8	12	21	4.2