

SPECIFICATIONS:

CONTACT RATING: Refer to "Contact material Options" for more info.

CONTACT RESISTANCE: 10mΩ max. initial @ 2-4VDC
100mA for both silver and gold plated contacts.

ELECTRICAL LIFE: 50,000 actuations at full load.

INSULATION RESISTANCE: 1,000M ΩMin.

DIELECTRIC STRENGTHS: 1,500V RMS @ sea level.

OPERATION TEMPERATURE: -30°C to + 85°C.

MATERIALS:

CASE: Diallyl phthalate(DAP)(UL 94V-0).

HOUSING: Stainless Steel.

SLIDE HANDLE: Nylon 6, black standard.

TERMINAL SEAL: Epoxy.

If your preferred product configuration is not shown, please contact our sales representative for custom design.

HOW TO ORDER SYSTEM

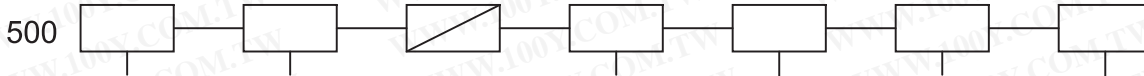

Switch Function

- SSP-1 On-None-On
- SSP-2 On-None-(On)
- SSP-3 On-Off-On
- SDP-1 On-None-On
- SDP-3 On-Off-On

Actuator

- S1 5.10 (.201") high
- S2 7.65 (.301") high
- S3 9.40 (.370") high
- S4 3.55 (.140") high
- S5 1.35 (.053") high
- S6 12.40 (.488") high
- S7 7.90 (.311") high
- T1 5.30 (.209") high

Actuator Color

- 1 White
- 2 Black
- 3 Red
- 4 Orange
- 5 Yellow
- 6 Green
- 7 Blue
- 8 Brown
- 9 Gray

Contact Material

- Q Silver
- P Silver (tin plated term.)
- R Gold
- K Gold (tin plated term.)
- G Silver (gold over silver term.)

Seal

- E Epoxy
- O Non-Epoxy

Termination

- M1 Solder lug
- M2 PC thru-hole
- M3 Quick connect
- M5-1 Wire wrap, 19.05 (.750") long
- M5-2 Wire wrap, 24.48 (.964") long
- M5-3 Wire wrap, 10.80 (.425") long
- M5-4 Wire wrap, 26.97 (1.062") long
- M6 Right angle, PC thru-hole
- M61 Right angle, snap-in
- M7 Vertical, right angle PC thru-hole
- M71 Vertical, right angle snap-in
- VS2 Vertical mount, 8.90 (.350") high
- VS3 Vertical mount, 14.60 (.575") high
- N1 M1 without mounting tabs

勝特力材料 886-3-5753170
胜特力电子(上海) 86-21-34970699
胜特力电子(深圳) 86-755-83298787
[Http://www.100y.com.tw](http://www.100y.com.tw)

SPDT



Model No.	Switching Position		
SSP-1	ON	NONE	ON
SSP-2	ON	NONE	(ON)
SSP-3	ON	OFF	ON
Term. Comm.	2-1	OPEN	2-3

Schematic

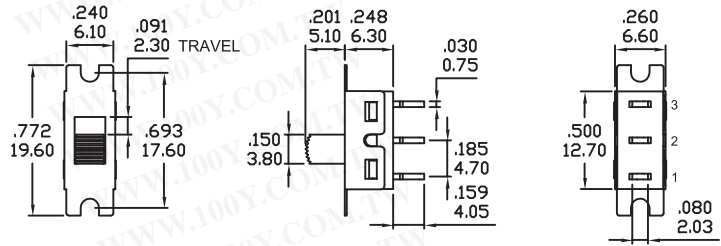

DPDT



Model No.	Switching Position		
SDP-1	ON	NONE	ON
SDP-3	ON	OFF	ON
Term. Comm.	2-1 5-4	OPEN	2-3 5-6

Schematic

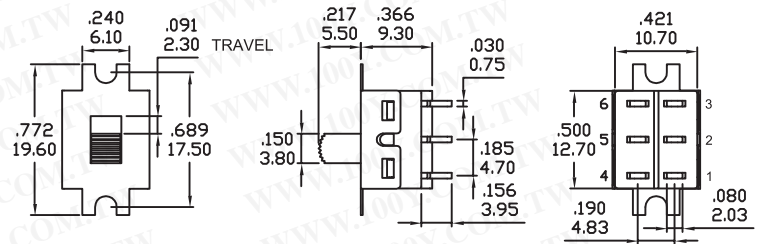
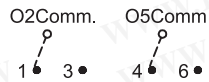

ACTUATOR OPTIONS

S1

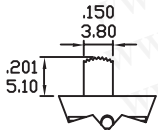

* Add 0.40 (.016) from actuator height for DPDT-M1 and M2 model.

S2

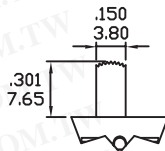

* Add 0.20 (.008) from actuator height for DPDT-M1 and M2 model.

S3

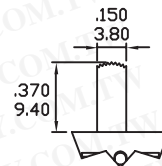

* Add 0.30 (.012) from actuator height for DPDT-M1 and M2 model.

S4

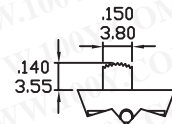

* Add 0.40 (.016) from actuator height for DPDT-M1 and M2 model.

* All actuator length shown is SPDT model with M1 and M2 terminals.

S5 FOR DPDT ONLY

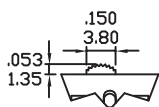

* Add 0.70 (.028) from actuator height for DPDT-M1 and M2 model.

S6

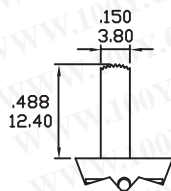

S7

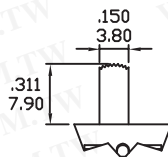

* Add 0.40 (.016) from actuator height for DPDT model.

T1 FOR DPDT ONLY

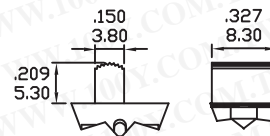

* All actuator length shown is SPDT model with M1 and M2 terminals.

ACTUATOR COLORS	
1	White
2	Black(Std.)
3	Red
4	Orange
5	Yellow
6	Green
7	Blue
8	Brown
9	Gray

TERMINATION OPTIONS

M1 STD. SOLDER LUG

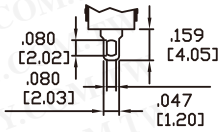

THK .030 (0.75)

* Standard with Mounting Tabs.

M2 PC THRU-HOLE

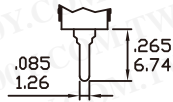

THK .030 (0.75)

M3 QUICK CONNECT

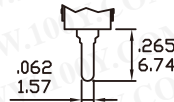

THK .030 (0.75)

M5 WIRE WRAP

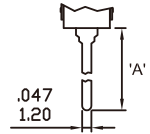

THK .030 (0.75)

OPTION CODE	DIM.'A'
M5-1	.750(19.05)
M5-2	.964(24.48)
M5-3	.425(10.80)
M5-4	1.062(26.97)

TERMINATION OPTIONS WITHOUT MOUNTING TABS

N1

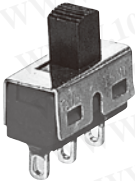

SPDT

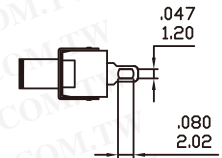
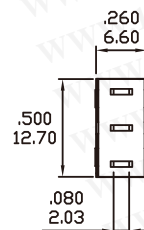
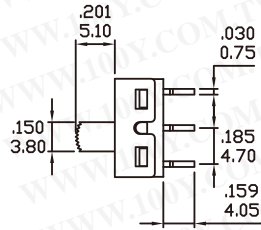
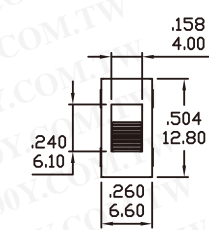

N1

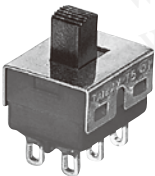

DPDT

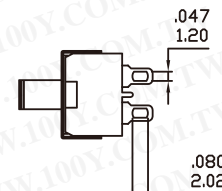
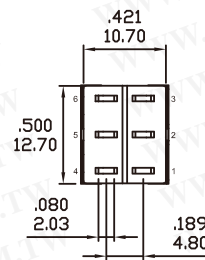
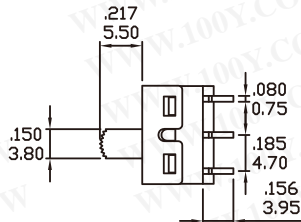
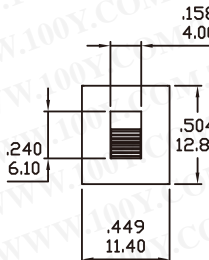

M6

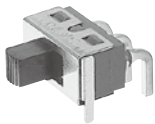

SPDT

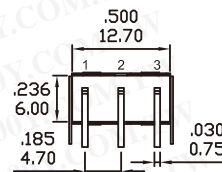
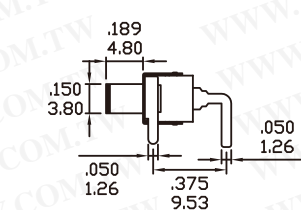
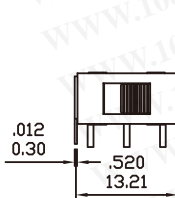

P.C.MOUNTING

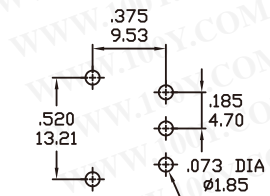

M6



DPDT

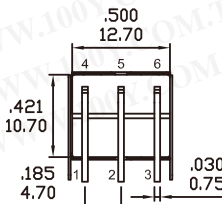
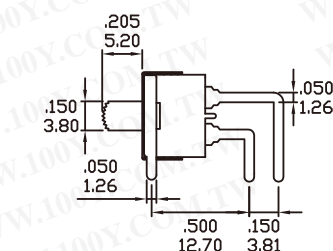
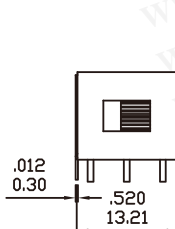

P.C.MOUNTING

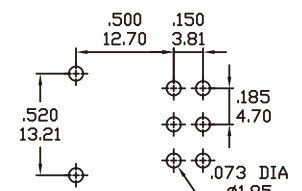

TERMINATION OPTIONS WITHOUT MOUNTING TABS

M7

P.C.MOUNTING

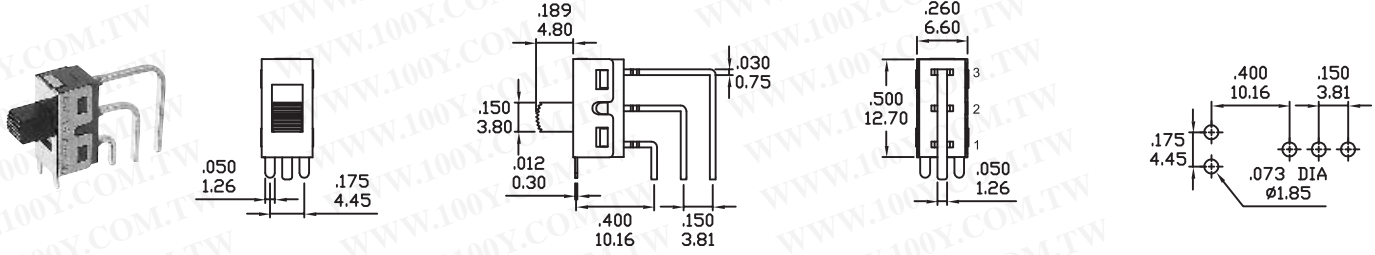

SPDT

M7

P.C.MOUNTING

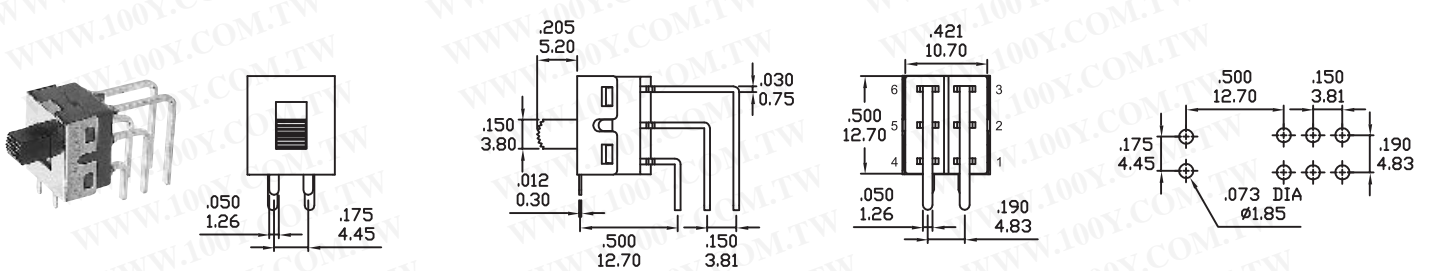

DPDT

VS-2

P.C.MOUNTING

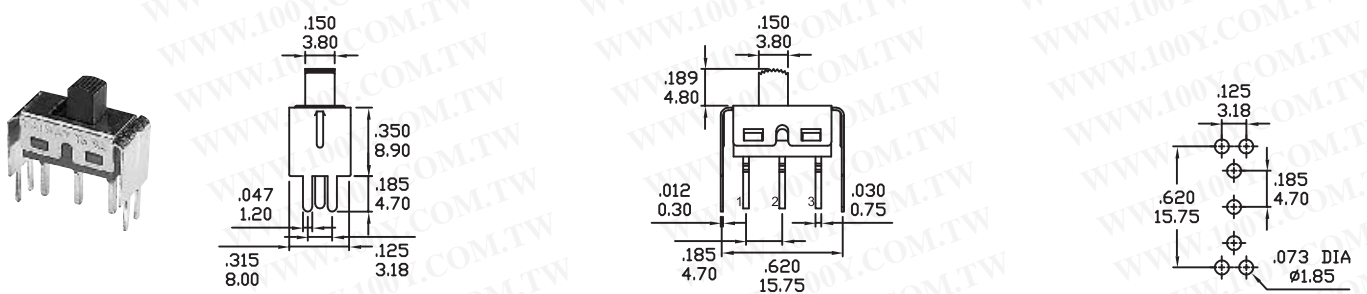

SPDT

VS-2

P.C.MOUNTING

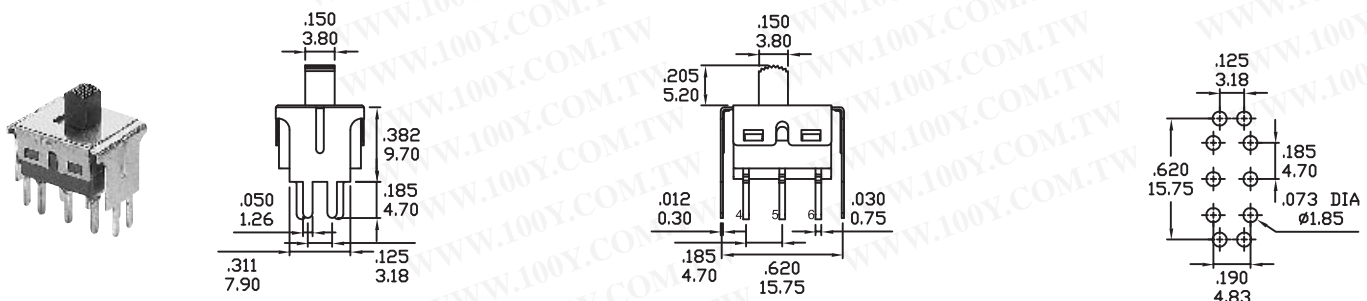

DPDT

TERMINATION OPTIONS WITHOUT MOUNTING TABS

VS-3

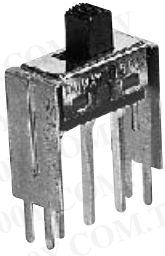

SPDT

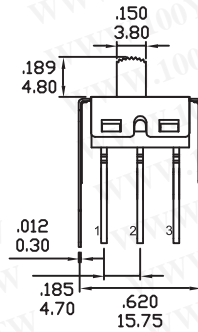
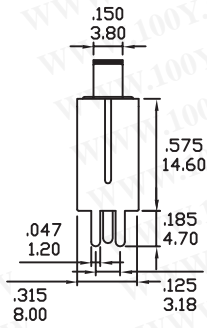

P.C.MOUNTING

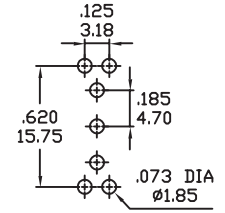

VS-3

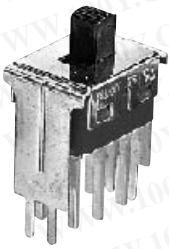

DPDT

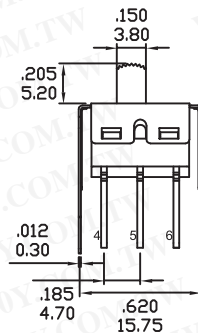
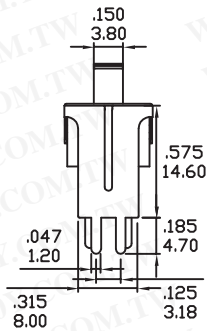

P.C.MOUNTING

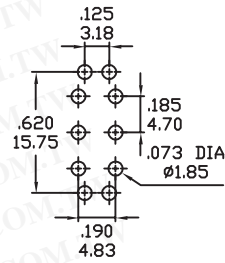

CONTACT MATERIAL OPTIONS

Coding	Contact Material	Terminal Plating	Rating	Agency Approvals
Q	Silver ¹	Silver plated ¹	5Amps @ 125VAC or 28VDC 2Amps @ 250VAC	
P		Tin plated ^{5 7}		
R	Gold ²	Gold plated ⁴	0.4VA max @ 20V max (AC or DC)	
K		Tin plated ^{5 6}		
G	Silver ¹	Gold over silver ³	5Amps @ 125VAC or 28VDC 2Amps @ 250VAC	

1. Movable Contact / Terminals: Copper alloy, silver plated.
2. Movable Contact: Copper alloy with gold plated over nickel plated.
3. Terminals: Silver plated with outer layer in gold plating.
4. Terminals: Copper alloy, with gold plated over nickel plated.
5. Outer Terminals: Copper alloy with pure tin plated.
6. Terminal Contact: Gold plated over nickel plated.
7. Terminal Contact: Palladium nickel alloy (or Silver) plated.

勝特力材料 886-3-5753170
勝特力电子(上海) 86-21-34970699
勝特力电子(深圳) 86-755-83298787
[Http://www.100y.com.tw](http://www.100y.com.tw)

* P, K is not available with M1 and M3 terminals

* 6Amps (Movable Contact: coin silver, silver plated) available with model ON-NONE-ON without UL approval