

- Operate Time..... $\leq 25\text{ms}$
- Release Time..... $\leq 25\text{ms}$
- Initial Dielectric Strength
 -50/60Hz 500VAC 1 min. (between open contacts)
 -50/60Hz 1500VAC 1 min. (between contacts and coil)
 -50/60Hz 1500VAC 1 min. (between contact sets)
- Vibration Resistance
 -Malfunction: 10 to 55Hz at Double Amplitude of 1.5mm
 -Destructive: 10 to 55Hz at Double Amplitude of 1.5mm
- Shock Resistance
 -Malfunction: 10G (11ms) / Destructive: 100G (6ms)
- Ambient Temperature..... $-25^{\circ}\text{C} \sim +55^{\circ}\text{C}$
- Relative Humidity..... 85% at 40°C
- Unit Weight.....Approx. 35g

ORDERING INFORMATION

951-1C -12 D P M L -G- F
 1 2 3 4 5 6 7 8 9

Type of Insulation..... Nil = Class A
F = Class F

Contact Material..... Nil = General Type
G = Contact with Gold Plating

Optional..... Nil = General Type
L = With Lamp and Diode (DC Coil Type Only)
N = With Lamp
B = With Push Button
T = With Lamp and Push Button
K = With Lamp and Diode and Push Button
 (DC Coil Type Only)

Cover Type..... Nil = General Type
M = Flange Top Type
S = Special Type
E = Special Flange Top Type

Terminal Type..... Nil = Socket Terminal
P = P.C.B. Terminal

Coil Type.....D: DC
A: AC

Coil Voltage..... DC: 6~100V
 AC: 12~270V

Contact Arrangement.....1A = 1 Form A (SPST-NO)
1B = 1 Form B (SPST-NC)
1C = 1 Form C (SPDT)
2C = 2 Form C (DPDT)

Model Number.....951

COIL RATINGS (at 20°C)

| COIL TYPE | Coil Nominal Voltage (V) | Coil Resistance ($\Omega \pm 10\%$) | Pick-Up Voltage (V) \leq | Drop-Out Voltage (V) \geq | Nominal Current (mA) |
|----------------------|--------------------------|---------------------------------------|----------------------------|-----------------------------|----------------------|
| DC Standard Coils | 6 | 40 | 4.5 | 0.6 | 150 |
| | 12 | 160 | 9 | 1.2 | 75 |
| | 24 | 650 | 18 | 2.4 | 37 |
| | 48 | 2600 | 36 | 4.8 | 19 |
| | 100 | 11000 | 75 | 10 | 9 |
| AC | 12 | 46 | 9 | 3.6 | |
| | 24 | 180 | 18 | 7.2 | |
| | 110 | 3750 | 82.5 | 33 | |
| | 120 | 4430 | 90 | 36 | |
| | 220 | 12950 | 165 | 66 | |
| | 240 | 18790 | 180 | 72 | |
| | 270 | 24150 | 202.5 | 81 | |

* Max Continuous Voltage at 20°C: 110% of Coil Nominal Voltage.

OUTLINE DIMENSIONS

Dimensions

**Internal Connections
(Bottom View)**

**Drilling Plan
(Bottom View)**

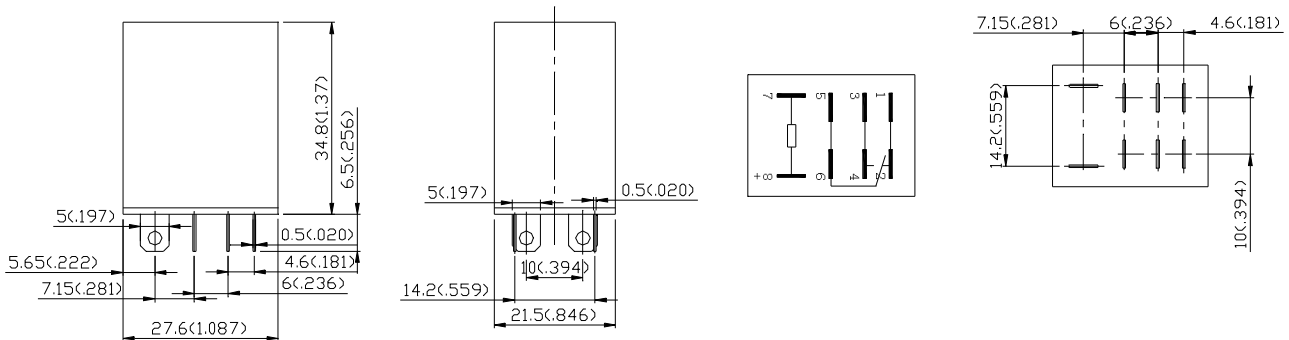

General Type

1 Form C

General Type

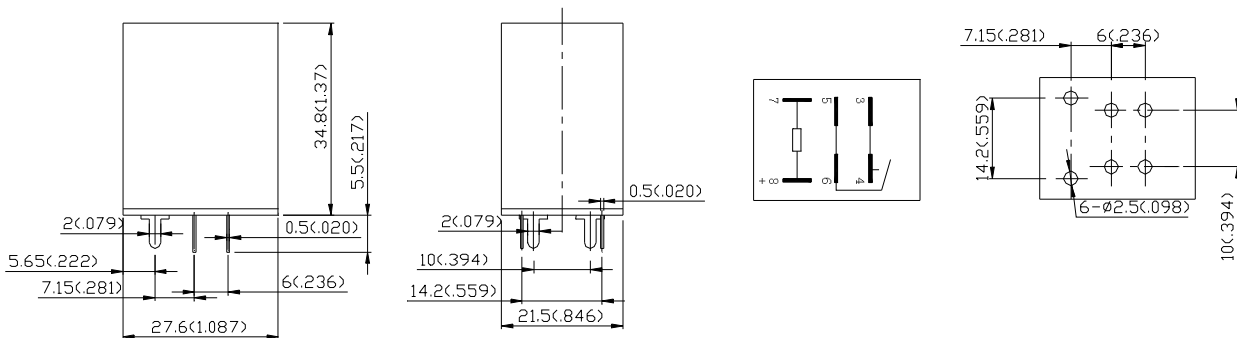

P.C.B Type

1 Form A

P.C.B Type

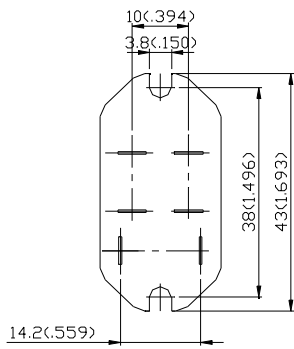

Outline Connect Type

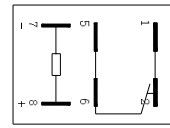
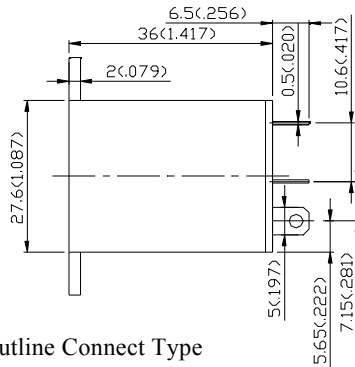

1 Form B

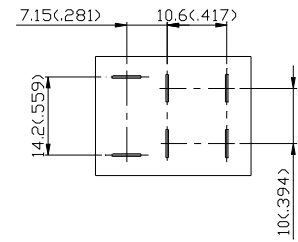

Outline Connect Type

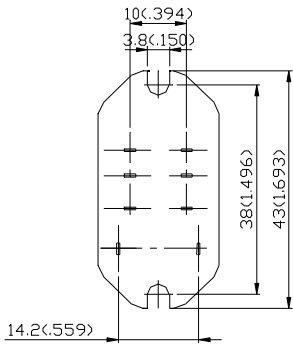

Outline Connect P.C.B Type

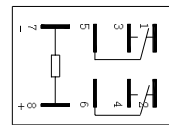
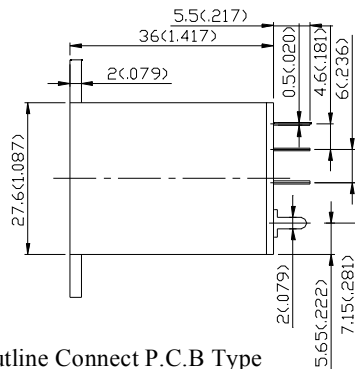

2 Form C

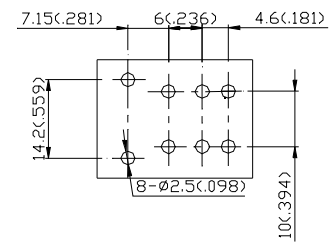

Outline Connect P.C.B Type

REMARK: 1.Tolerance of outline dimensions: $\pm 0.2(.008)$.

2.The polarity of coil is only applied for DL, DN, DPL and DPN type.

UNIT: mm (inch)

勝特力電材超市-龍山店 886-3-5773766
 勝特力電材超市-光復店 886-3-5729570
 勝特力电子(上海) 86-21-34970699
 勝特力电子(深圳) 86-755-83298787
<http://www.100y.com.tw>