

R3-54B

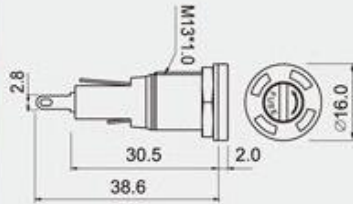

⊔ (2.8mm)0.109"
Solder

10A 125V AC/6.3A 250V AC
⌀ 0.7~3.5mm

FEATURES:

- Material:
Frame and cap: nylon(UL flame: 94V-2).
Terminal: silver plated copper.
- Mounted by nut.

CAP

FUSE

Screw type
(tool release)

⌀ 5.0*20mm

CUT-OUT



R3-54

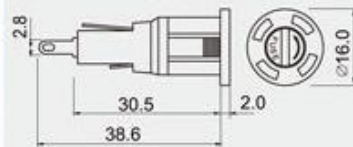

⊔ (2.8mm)0.109"
Solder

10A 125V AC/6.3A 250V AC
⌀ 0.75~3.5mm

FEATURES:

- Material:
Frame and cap: nylon(UL flame: 94V-2).
Terminal: silver plated copper.
- Snap-in mounting, easy to install fuse holder into panel.

CAP

FUSE

Screw type
(tool release)

⌀ 5.0*20mm

CUT-OUT

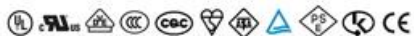
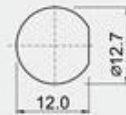

尺寸仅供参考，难免会有少许误差，请以实物为主

名称	保险丝座	电流电压	6.3A250V / 10A125V
型号	R3-54B	开孔尺寸	12.7mm
规格	5*20 三牛电子	包装	200只/包 三牛电子

产品细节

Model No.	FUSE SIZE	額定電流/電壓	Cap Type	Safety	Approved
R3-9	 R3-9A 6.35*31.8mm R3-9C 6.4*30mm R3-9CO 6.4*30mm	15A 250V AC	Bayonet Screw		UL/CSA
R3-11	 R3-11 5.0*20mm R3-11B 5.0*20mm	10A 250V AC	Bayonet Screw		UL/CSA
R3-12	 5.0*20mm	10A 250V AC	Screw		UL/CUL/CSA
R3-12E	 5.0*20mm	10A 250V AC	Screw		UL/CUL/CSA
R3-13	 6.35*31.8mm	10A 250V AC	Screw		UL/CUL/CSA
R3-13E	 6.35*31.8mm	10A 250V AC	Screw		UL/CUL/CSA
R3-14A	 R3-14A 6.35*31.8mm R3-14A2 6.35*31.8mm	R3-14A10A 250V AC R3-14A230A 250V AC	Bayonet		UL/CUL/CSA
R3-14C	 6.35*31.8mm	10A 250V AC	Bayonet		UL/CUL/CSA

R3-14D		6.35*31.8mm	10A 250V AC	Bayonet	UL/CUL/CSA
R3-21A		6.0*30mm	10A 250V AC	Bayonet	UL
R3-22A		6.35*31.8mm	10A 250V AC	Screw	UL/CSA
R3-26		5.0*20mm	10A 250V AC	Screw	UL
R3-28A		6.35*31.8mm	15A 250V AC	Bayonet	UL/CSA
R3-28C		6.35*31.8mm	15A 250V AC	Screw	CUL/CSA
R3-44		R3-44AA 6.35*31.8mm R3-44BA 5.0*20mm R3-44CA 6.35*31.8	15A 250V AC	Bayonet Bayonet Screw	CUL/CSA
R3-45		R3-45A 5.0*20mm R3-45B 6.35*31.8mm	R3-45A 8A 250V AC R3-45B 10A 250V AC		UL/CSA

R3-46		R3-46A 6.35*31.8mm R3-46B 5.0*20mm R3-46C 6.35*31.8mm	15A 250V AC	Bayonet Bayonet Screw	CUL/CSA
R3-49		R3-49A 6.35*31.8mm R3-49C 6.35*31.8mm	10A 250V AC	Bayonet Screw	UL
R3-53 AA		6.35*31.8mm	15A 250V AC	Screw	UL/CUL
R3-54		5.0*20mm	6.3A 250V AC 10A 125V AC	Screw	UL/CUL/VDE
R3-54B		5.0*20mm	6.3A 250V AC 10A 125V AC	Screw	UL/CUL/VDE
R3-55A		6.35*31.8mm	20A 250V AC	Screw	CUL
R3-55B		6.35*31.8mm	20A 250V AC	Screw	CUL
R3-57		5.2*20mm	10A 250V AC	Bayonet	

R3-61		6.35*31.8mm	10A 250VAC	Screw	
-----------------------	---	-------------	------------	-------	--
