

SPES-32L SCRS-32L (AC/DC 12V/24V) LED燈泡

本產品榮獲國家專利第165769號

多層式LED警示燈燈殼，採用多層次多角的光線折射原理，可投射出更亮、更清晰的光源，更具醒目的警示效果增加產品的實用性與美觀功能，全部使用LED燈泡擁有穩定的光源效果及五萬小時以上的超耐久壽命。內含蜂鳴器以提高警示效果。

By using multi-layers and multi-angles light refracting principles, lens of tower light projects brighter and clearer illuminant providing better warning effect and increasing practical & artistic functions.

LED bulbs possess stable illuminant effect and also durable service life over 50,000 hours. Interior buzzer increases better warning effect.



尺寸圖(高度=層數X 30+69+9)

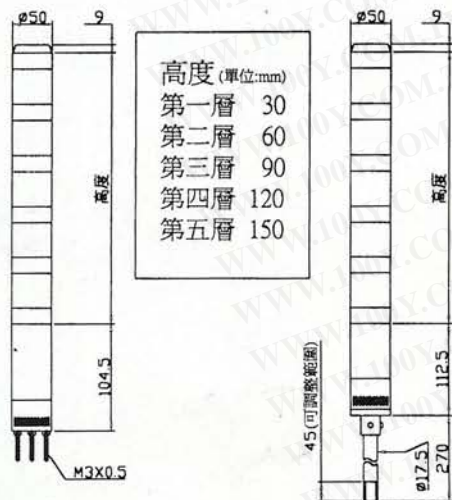

D-直付式孔位尺寸圖

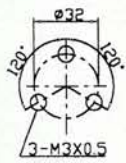

PB-鐵架式尺寸圖(可選用)

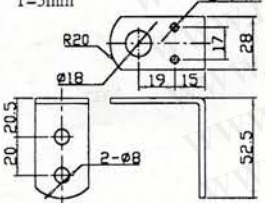

R-塑膠圓盤尺寸圖

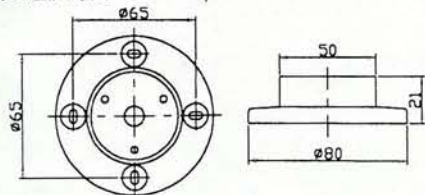

配線圖

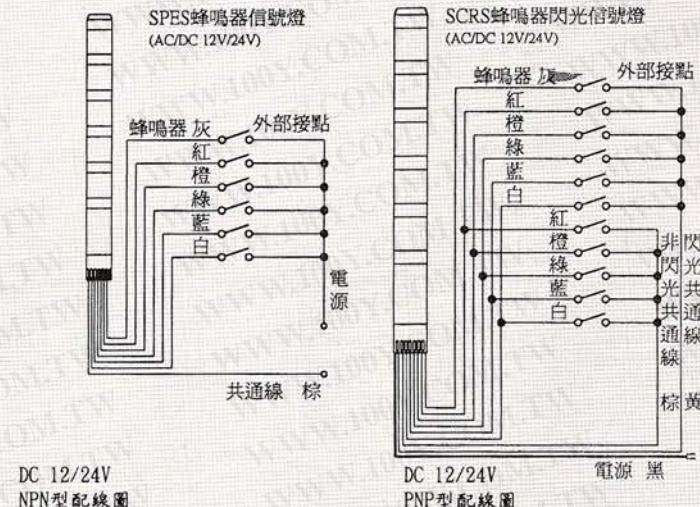

DC 12/24V
NPN型配線圖

DC 12/24V
PNP型配線圖

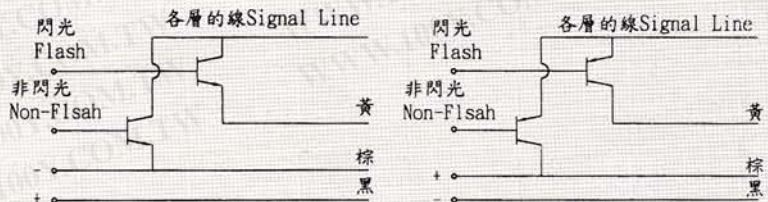

電源電壓 Voltage type	AC/DC 12V	AC/DC 24V
燈泡 Bulb	LED 燈泡	LED 燈泡
每層燈泡所消耗的電流 Current consumption	0.05A	0.035A
突波電流 Rush Current	約0.5A	約0.35A
外部接點容量 Output contact	1A以上	0.7A以上
蜂鳴器所消耗的電流	20mA	