

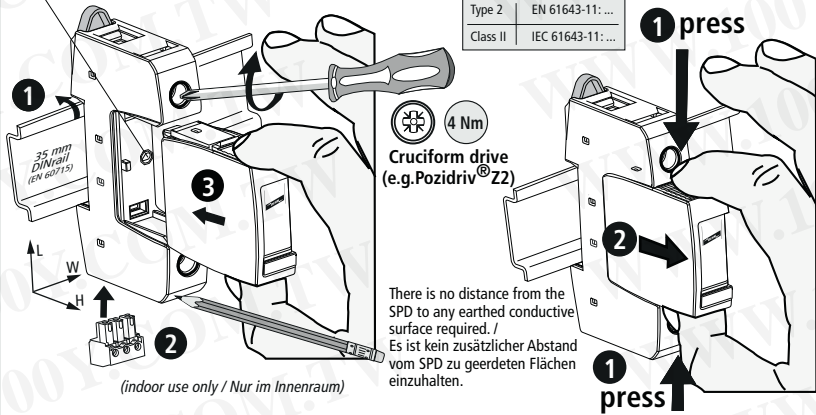

DEHNguard S® DG S ... (FM)

U_C Code: 48V, 75V, 150V, 275V, 320V, 385V, 440V, 600V



Technical data / Technische Daten

type DG S ... (FM)	48	75	150	275	320	385	440	600	
U _N / Tol.: 0V ... U _C	42 V	60 V	120 V	230 V	230 V	230 V	400 V	480 V	
U _C	48 V~	75 V~	150 V~	275 V~	320 V~	385 V~	440 V~	600 V~	
f _N	50 / 60 Hz								
max. I	125 A gG								
I _{max}	25 kA	40 kA	40 kA	40 kA	40 kA	40 kA	40 kA	30 kA	
I _{SCCR}	50 kA _{rms}				25 kA _{rms}				
g° C	-40°C ... + 80°C								
humidity / Feuchte	5% ... 95%								
I _{PE}	< 0,5 mA								
Ports	1								
IP-Code	IP 20 (built in / eingebaut)								
L x W x H	90 mm x 18 mm x 73 mm								
Additional technical data for DC / Ergänzende technische Daten für DC									
U _{C,DC}	--	100 V-	200 V-	350 V-	420 V-	500 V-	585 V-	600 V-	
max. I	--	--	80 A gG	--	--	80 A gPV	--	--	
I _{SCCR}	--	--	--	5000 A-					--

Backup fuse / Vorsicherung

DEHNguard S DG S ... (FM)			
Typ	48, 75, 150, 275, 320, 385, 440	600	
F1	F1 > 125 A gG ↓ F2 ≤ 125 A gG	F1 > 100 A gG ↓ F2 ≤ 100 A gG	
F2	F1 ≤ 125 A gG ↓ ⊗	F1 ≤ 100 A gG ↓ ⊗	

DG S ... (FM)				
Type / Typ	48, 75, 150, 275, 320, 385, 440	600		
Fuse F1 A gG	S ₂ / mm ²	S ₃ / mm ²	Fuse F2 A gG	Fuse F2 A gG
25	4	6	---	---
35	4	6	---	---
40	4	6	---	---
50	6	6	---	---
63	10	10	---	---
80	10	10	---	---
100	16	16	---	---
125	16	16	---	100
>125	16	16	125	100

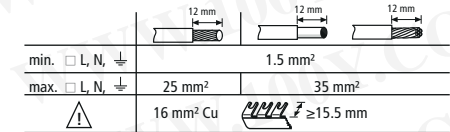

TN-C

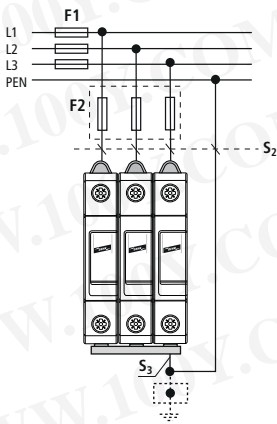

TN (-C) -S

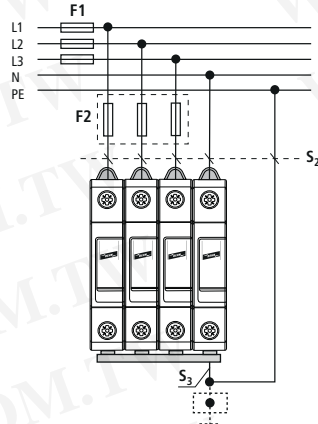
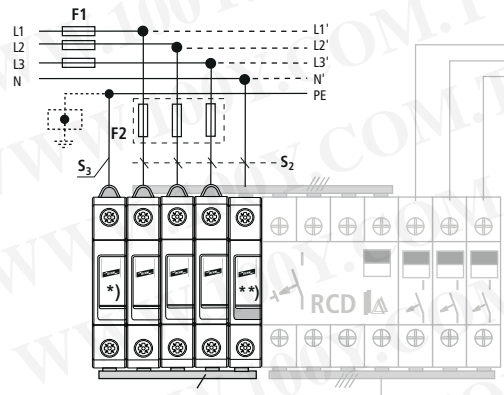

Fig. a TT 3+1



*) DEHNgap C S
 DGP C S (FM)
 Part No. 952 030 (035)

**) Feed through terminal
 DK 25
 Part No. 952 699

Coordination / Koordination

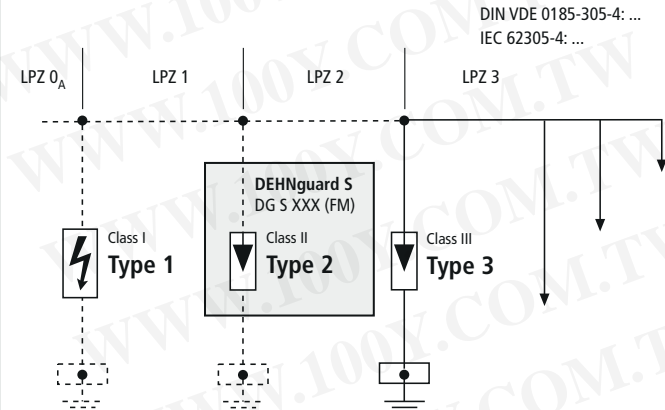

Fault indication / Defektanzeige

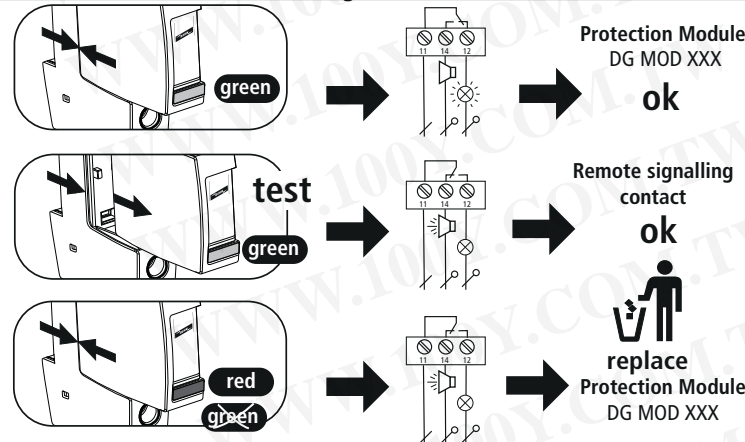

Remote signalling contact / Fernmeldekontakt

DEHNguard S DG S XXX FM	
	AC: 250 V / 0.5 A DC: 250 V / 0.1 A 125 V / 0.2 A 75 V / 0.5 A
max. 1.5 mm ²	