

Nibbling Tool

勝特力材料 886-3-5753170
 勝特力电子(上海) 86-21-54151736
 勝特力电子(深圳) 86-755-83298787
[Http://www.100y.com.tw](http://www.100y.com.tw)

HT-204 Cuts sheet plate like chassis punch; cuts up to 18 AWG soft metal, 1/16" soft plate. For inside shape, drilled a 3/8" or 9.5 ϕ hole for starting cuts.

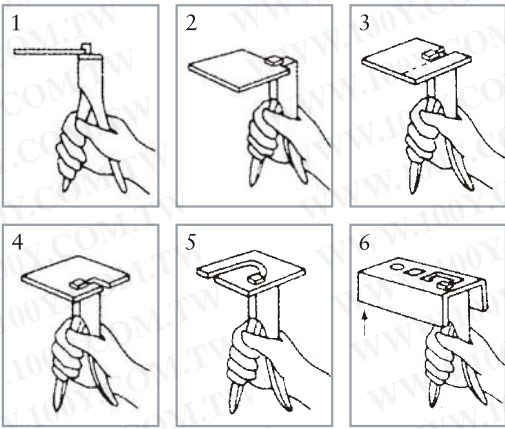

HT-204
7.3" (184mm)

1. Material to be nibbled is placed in the gap between the punch and blade channel.
2. By squeezing the handles together, the punch will move down into the channel, cutting out a slug of metal.
3. A scribe line can be followed by looking down on work in this position. A slot is cut by making successive cuts.
4. To make sharp 90 degree turn, pull the tool out of the slot. Turn the work 90 degrees and insert the tool again.
5. By turning the tool before each cut, a 5/16" (7.9mm) minimum radius can be cut.
6. Almost any size or shape hole can be cut by starting with a 3/8" (9.5mm) hole.

IDC Crimping Fixture & Attachment

HT-214 For crimping IDC-type of connectors on to ribbon cable. Crimping from height 6mm distance to 27.5mm (max. 55mm width)

HT-214D For crimping DIP plug, special attachment with dual slot for the plug distance "D" in 0.1", 0.3" & 0.6". (max. 58mm width)

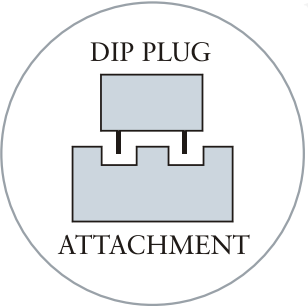
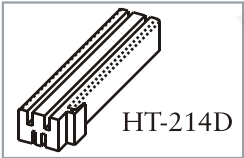
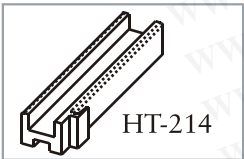

HT-214
9.5" (241mm)
Patented

